

Belt Sway Switch

To prevent the material from falling from a conveyor

To protect the edge of conveyor belt from the contact with the frame



Two degree signals for conveyor automation

20 deg. : Alarm signal of conveyor misalignment

35 deg. : Control for conveyor stop against any more misalignment

FEATURES

- It is highly durable with options (special coating or SUS material touch pulley) under corrosive environment including fertilizer plant.
- It has a long life span and nice for conveyor belt by robust touch pulley with high quality bearing.
- It is easy to adjust two operational degrees at a site.
- It is a long life span in tropical countries by moisture resistance microswitch.

SPECIFICATIONS

Inclination angle of touch pulley		MAX 75°	Temperature	Weather proof	-20°C - +60°C
Operating torque of touch pulley		3.4 - 5.4Nm(0.35 - 0.55kgfm)		Dust-ignition-proof	
Contacts		2C		Flameproof	-10°C - +40°C
Capacity of contact		15A-125, 250VAC 1/2A-125VDC	Enclosure	Weather proof	IP67
Lead outlet	Weather proof Dust-ignition-proof	G 1/2		Dust-ignition-proof	Ex tDA21 IP68 T85°C
	Flameproof	G 3/4		Flameproof	d2 G4
			Coating color		Munsell 7.5GY6/10

APPEARANCE & DIMENSION



ELAP-20
Weather proof
MASS/2.9kg

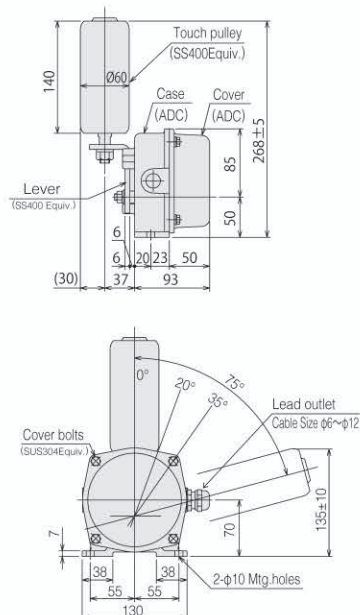

ELADP-80
Dust-ignition-
proof type
MASS/2.9kg

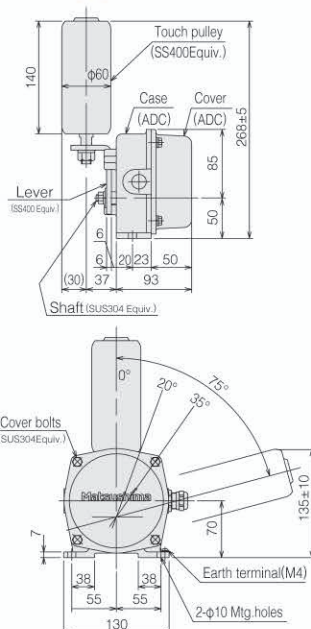

ELAM-10
Flameproof
MASS/13kg

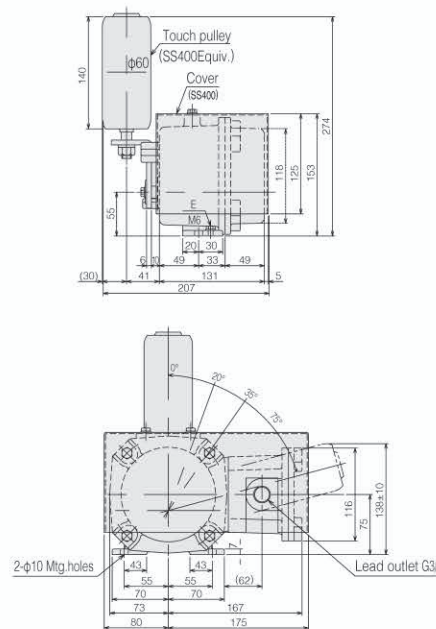

INSTALLATION EXAMPLE

Each dimension shown in the figures is based on a three-trough type belt conveyor, trough angle 20°, and belt width 600mm. For large belt width, compute dimensions of setting base by referring to the figures.

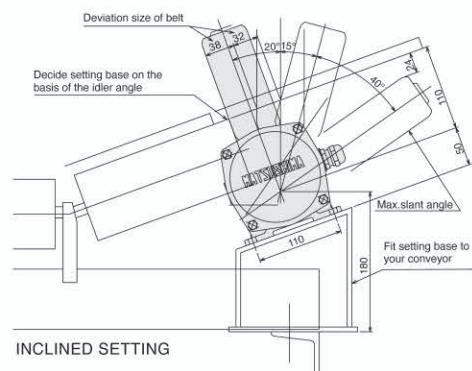

INCLINED SETTING

Specifications are subject to change without notice.
All Rights Reserved Copyrights©2025, Matsushima Measure tech Co., Ltd.

OPERATION

- The angles shown in the figure are the slant angles of the touch pulley.
- The contact 1-2 closes at 20° slant, and opens at 18° in reset.
- The contact 4-5 opens at 35° slant, and closes at 33° in reset.
- Action position of the contacts (limit switches) can be changed by adjusting the cams.

Setting error ±2°

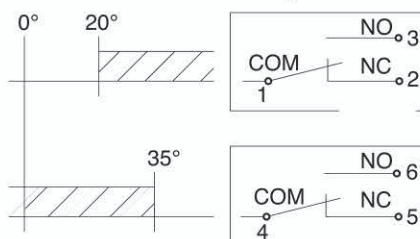

Caution
● Read the instructions to ensure correct and suitable application of products.
● Contact our nearest sales office when using our products for any systems used in situations which may be life threatening.

Distributor



Matsushima Measure Tech Co., Ltd.

HEAD OFFICE
1-8-18, NORIMATSU-HIGASHI, YAHATANISHI-KU, KITAKYUSHU, 807-0837 JAPAN
Tel: +81-93-691-3731 FAX: +81-93-691-3735
https://www.matsushima-m-tech.com E-mail: info@matsushima-m-tech.com

Seoul Branch
220, 2F Hyundai Knowledge Industry Center, 70, Dusan-ro, Geumcheon-gu, Seoul, Republic of Korea
Tel: +82-(0)2-852-3731 FAX: +82-(0)2-852-3734

Affiliated company
Shanghai Dahong Matsushima Machinery Co., Ltd.
70 Hengchang Road, Dahong, Malu, Jiading, Shanghai 201818, China
Tel: +86-(0)21-5951-4138 FAX: +86-(0)21-5951-4139